

Metric No. 4.1.1

Availability of adequate infrastructure and physical facilities viz., classrooms, laboratories, ICT facilities, cultural activities, gymnasium, yoga centre etc. in the institution



Area Statement

Pune District Education Association's Shankarrao Ursal College of Pharmaceutical Sciences and Research Centre, Kharadi, Pune.



Adorn Architects & Designers
Ar. Akshay Vilas Newase (B. Arch)

ARCHITECTURE . INTERIOR . LANDSCAPE

AREA STATEMENT			
A) INSTRUCTIONAL AREA			
SR. NO	ROOM NO	PARTICULARS	AREA (SQ.M)
1	110	CLASS ROOM -1	105.36
2	113	CLASS ROOM -2	91.6
3	114	CLASS ROOM -3	90.8
4	209	CLASS ROOM -4	83.25
5	302	CLASS ROOM -5	77.45
6	313	CLASS ROOM -6	75.43
7	314	CLASS ROOM -7	75.43
8	404	CLASS ROOM -8	76.4
9	309	TUTORIAL ROOM -1	42.2
10	401	TUTORIAL ROOM -2	51.77
11	402	TUTORIAL ROOM -3	51.77
12	403	TUTORIAL ROOM -4	51.77
13	405	TUTORIAL ROOM -5	90
14	101	PHARMACEUTICS LAB -1	77.86
15	102	PHARMACEUTICS LAB -2	77.45
16	103	PHARMACEUTICS LAB -3	76.87
17	213	PHARMACEUTICS LAB -4	91.6
18	308	PHARMACEUTICS LAB -5	83.25
19	104	M PHARM PHARMACEUTICS LAB	93.98
20	201	PHARMACEUTICAL CHEMISTRY LAB -1	77.86
21	202	PHARMACEUTICAL CHEMISTRY LAB -2	77.45
22	307	PHARMACEUTICAL CHEMISTRY LAB -3	83.22
23	303	PHARMACOLOGY LAB -1	76.87
24	304	PHARMACOLOGY LAB -2	93.98
25	311	PHARMACOLOGY LAB -3	91.6
26	207	PHARMACOGNOSY LAB -1	84.73
27	312	PHARMACOGNOSY LAB -2	90.8
28	206	M PHARM P.Q.A. LAB	84.73
29	205	PHARMACEUTICAL ANALYSIS LAB	90.82
30	208	COMPUTER LAB / LANGUAGE LAB	86.75
31	204	CENTRAL INSTRUMENT ROOM	80.03
32	215	LIBRARY	230
33	001	PHARMACY INDUSTRIAL LAB / MACHINE ROOM	155.31
34	004	ASEPTIC ROOM	34.03
35	005	RESEARCH LABORATORY	75.19
36	203	BALANCE ROOM	10.7
37	305	SEMINAR HALL	171.15
38	214	INSTRUMENT ROOM	60.05
39	124	MUSEUM	60
40	G1	HERBAL GARDEN	400
(A) TOTAL INSTRUCTIONAL AREA			3679.51

AKSHAY V. NEWASE
Regd. Architect
CA/2018/97103

E-MAIL : ADORNARCHSTUDIO@GMAIL.COM CONTACT NO : +91 9607 281000

B/116 SHIVSAHNKAR APPARTMENT .SHIVTITHA NAGAR KHOTHRUD PUNE -411038



Adorn Architects & Designers
Ar. Akshay Vilas Newase (B. Arch)

ARCHITECTURE . INTERIOR . LANDSCAPE

B) ADMINISTRATIVE AREA			
SR. NO	ROOM NO	PARTICULARS	AREA (SQ.M)
41	119	PRINCIPAL CABIN	35.3
42	115	VICE PRINCIPAL CABIN	30.1
43	116	ADMINISTRATIVE AREA	91.5
44	310	NSS ROOM	20.05
45	109	STORE ROOM-1	100
46	210	STORE ROOM-2	21.1
47	121	RECORD ROOM -1	30.7
48	003	RECORD ROOM -2	84.13
49	111	MAINTENANCE ROOM	30.07
50	106	HOD CABIN (DIPLOMA)	10.7
51	107	STAFF ROOM	80.46
52	118	PANTRY	10.7
53	120	BOARD ROOM	55.8
54	112	HOD ROOM -1	20.02
55	211	HOD ROOM -2	21.1
56	212	HOD ROOM -3	20.05
57	105	IQAC ROOM	37.15
58	315	EXAM CONTROL OFFICE	65.12
59	316	TRAINING AND PLACEMENT CELL	31
60	G2	SECURITY CABIN	10.02
(B) ADMINISTRATIVE AREA			805.07

C) AMENITIES AREA			
SR. NO	ROOM NO	PARTICULARS	AREA (SQ.M)
61	122	GIRLS COMMON ROOM	75.2
62	301	BOYS COMMON ROOM	77.86
63	002	GYMNASIUM	64.08
64	123	PH. TOILET	10.7
65	217	TOILET (GIRLS)	21.67
66	218	TOILET (BOYS)	21.67
67	318	TOILET (GIRLS)	21.67
68	319	TOILET (BOYS)	21.67
69	306	STAFF TOILET	12.1
70	317	TOILET	4.62
71	108	TOILET	6.2
72	117	TOILET	8.1
73	216	FIRST AID CUM SICK ROOM	11.4
74	G3	CANTEEN	153
75	G4	STAFF PARKING	200
76	G5	STUDENT PARKING	450
77	G6	AMPHITHEATOR	640
(C) AMENITIES AREA			799.94
(D) CIRCULATION AREA			777.46
(E) TOTAL			7061.98

AKSHAY V. NEWASE
Regd. Architect
CA/2018/97103

E-MAIL : ADORNARCHSTUDIO@GMAIL.COM CONTACT NO : +91 9607 281000

B/116 SHIVSAHNKAR APPARTMENT .SHIVTITHA NAGAR KHOTHRUD PUNE -411038

Floor Plan

Pune District Education Association's Shankarrao Ursal College of Pharmaceutical Sciences and Research Centre, Kharadi, Pune.

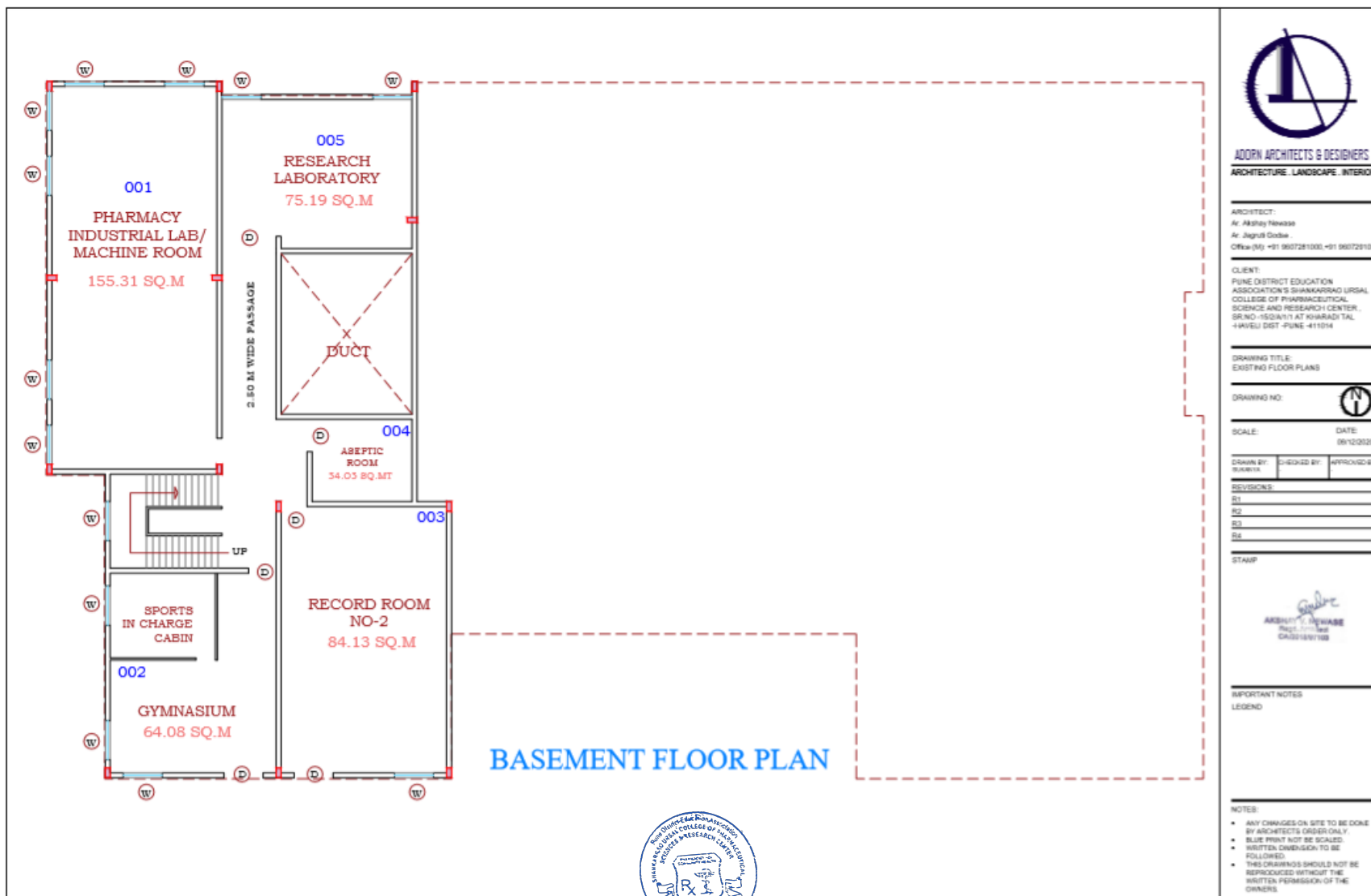

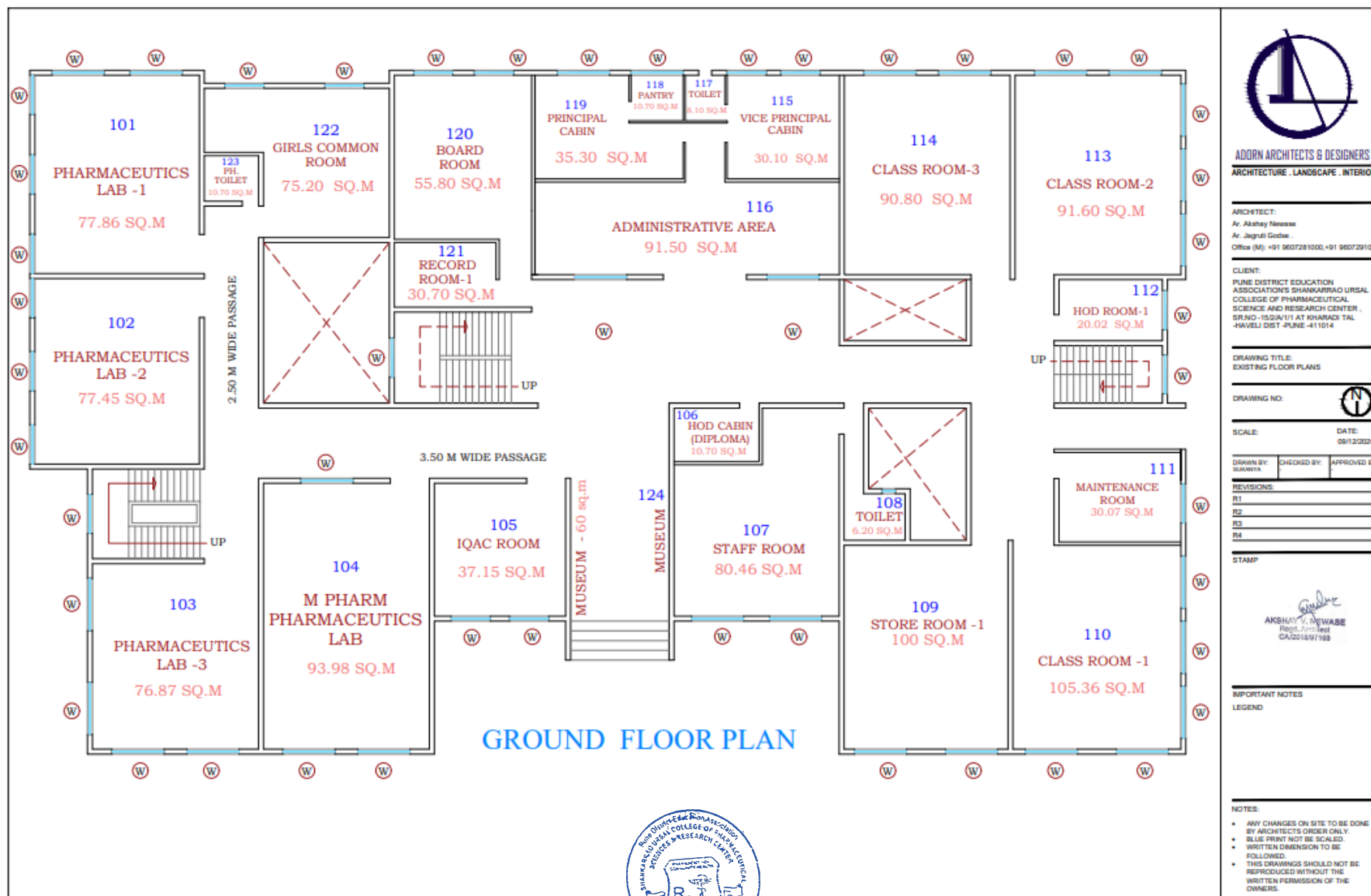

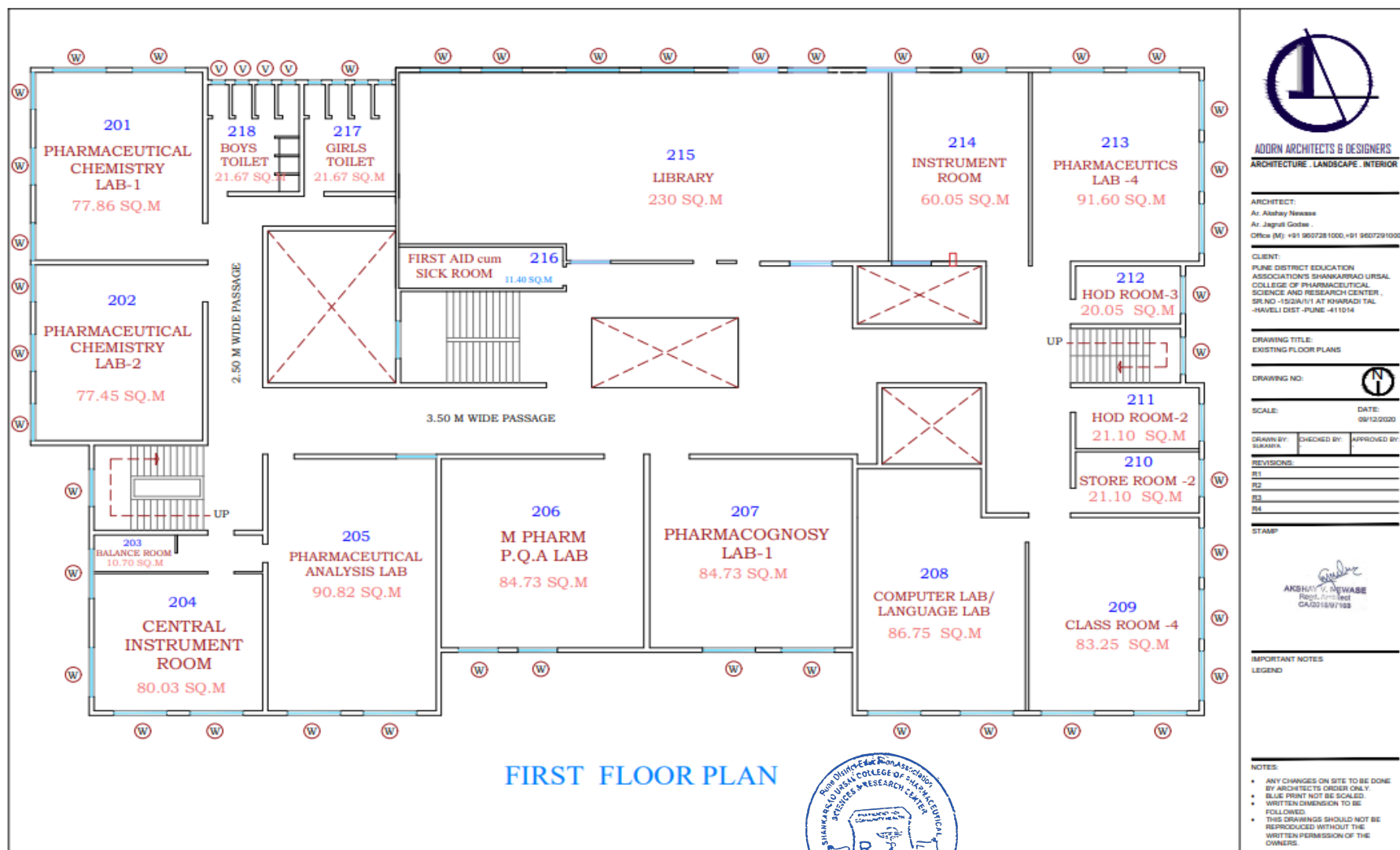

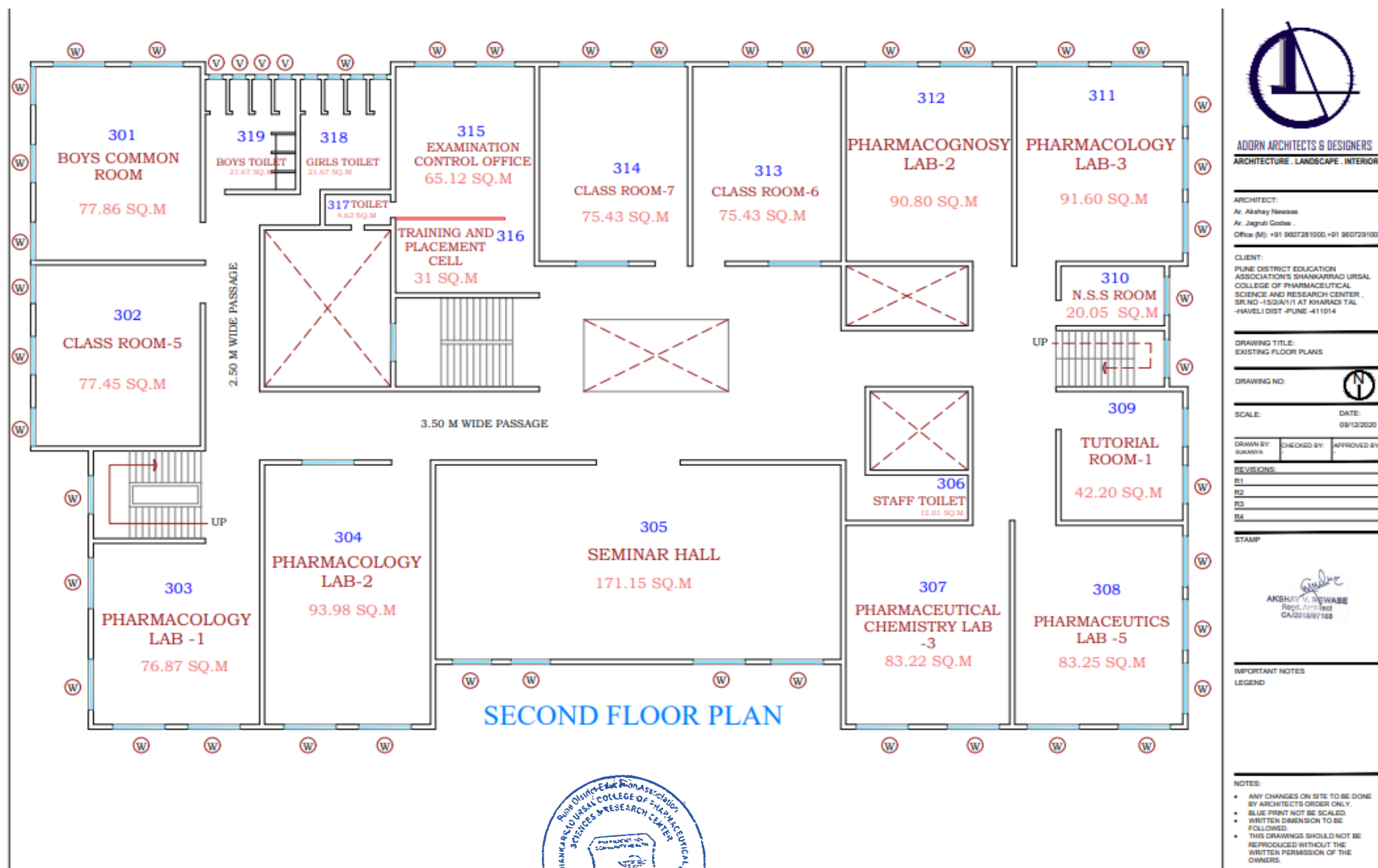

Pune District Education Association's Shankarrao Ursal College of Pharmaceutical Sciences and Research Centre, Kharadi, Pune.

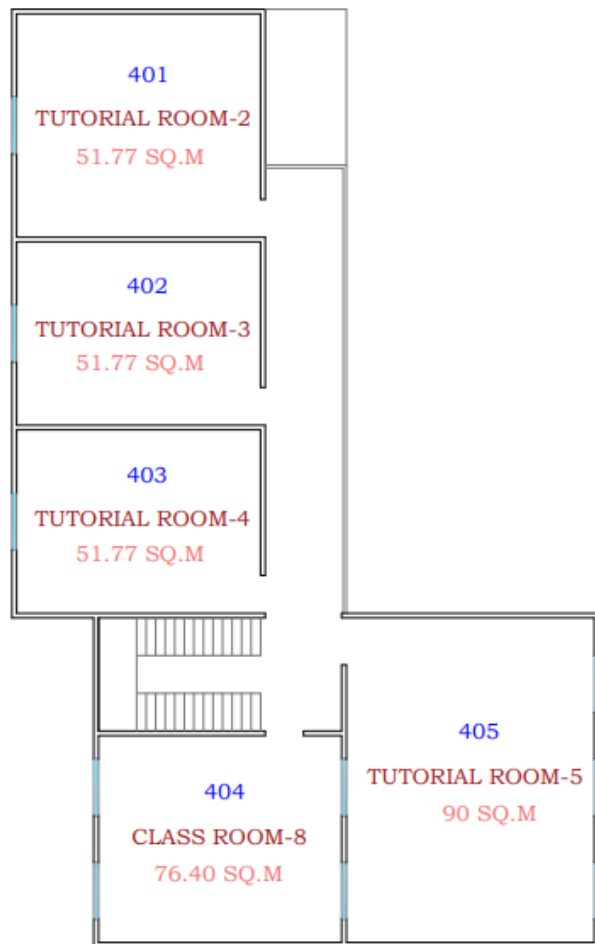

TERRACE FLOOR PLAN



ADORN ARCHITECTS & DESIGNERS
ARCHITECTURE . LANDSCAPE . INTERIOR

ARCHITECT:
Ar. Akshay Newase
Ar. Jagruti Godse
Office (M) +91 9607281000, +91 9607281000

CLIENT:
PUNE DISTRICT EDUCATION
ASSOCIATION'S SHANKARRAO URSAI
COLLEGE OF PHARMACEUTICAL
SCIENCE AND RESEARCH CENTER,
SR.NO - 152/A/1/1 AT KHARADI TAL
-HAVELI DIST -PUNE -411014

DRAWING TITLE:
EXISTING FLOOR PLANS

DRAWING NO: 

SCALE: DATE: 09/12/2020

DRAWN BY: SUBMITT CHECKED BY: APPROVED BY:

REVISIONS:
R1
R2
R3
R4

STAMP

AKSHAY V. NEWASE
Regd. Architect
GA/2218/1/103

IMPORTANT NOTES
LEGEND

NOTES:
• ANY CHANGES ON SITE TO BE DONE BY ARCHITECTS ORDER ONLY.
• BLUE PRINT NOT BE SCALED.
• WRITTEN DIMENSION TO BE FOLLOWED.
• THIS DRAWINGS SHOULD NOT BE REPRODUCED WITHOUT THE WRITTEN PERMISSION OF THE OWNERS.

A. Instructional area



PRINCIPAL
Pune District Education Association's
Shankarrao Ursal College of Pharmaceutical
Sciences & Research Centre,
Kharadi, Pune-411014.

Class room

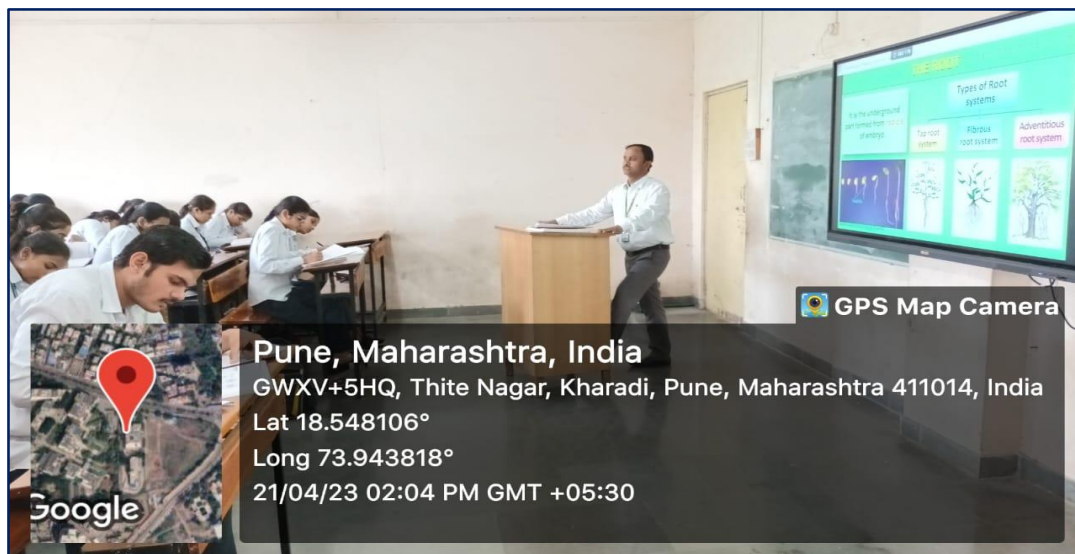

Students use ICT facility in Classroom



Laboratories

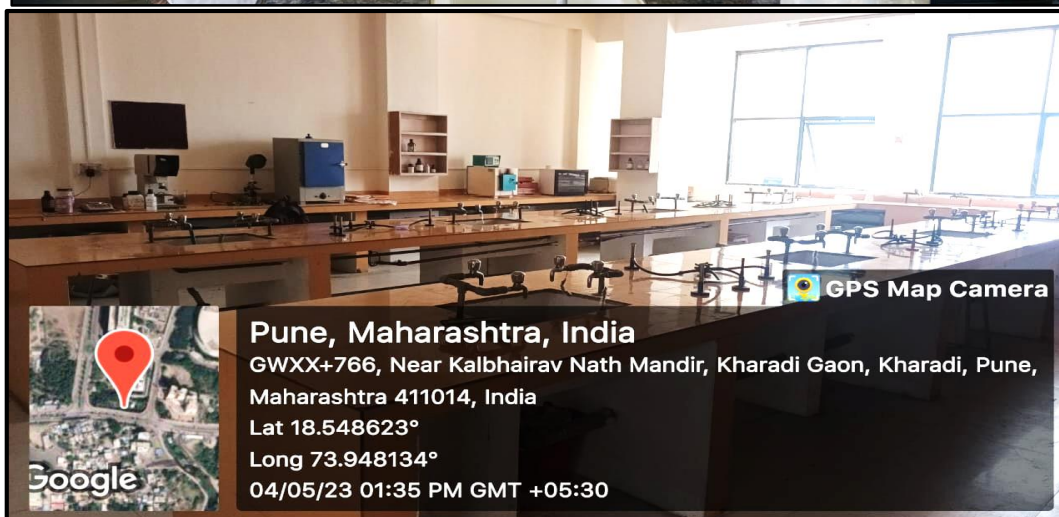



PRINCIPAL
Pune District Education Association's
Shankarrao Ursal College of Pharmaceutical
Sciences & Research Centre,
Kharadi, Pune-411014.

Seminar hall



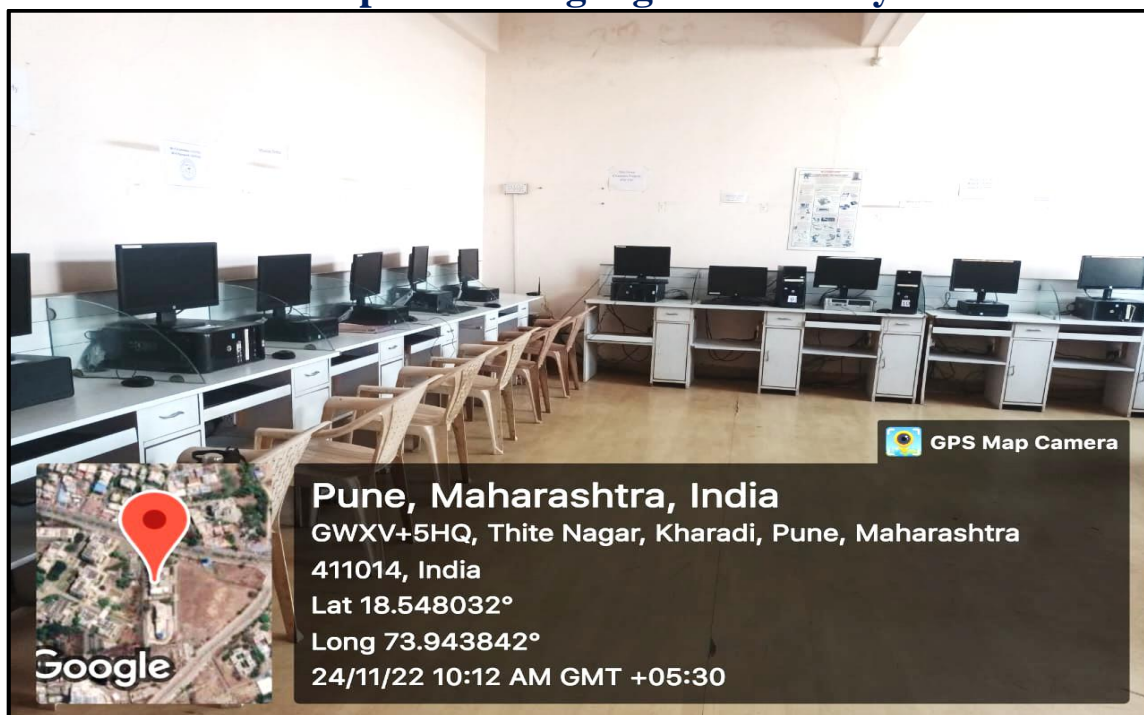

PRINCIPAL
Pune District Education Association's
Shankarrao Ursal College of Pharmaceutical
Sciences & Research Centre,
Kharadi, Pune-411014.

Computer / Language Laboratory

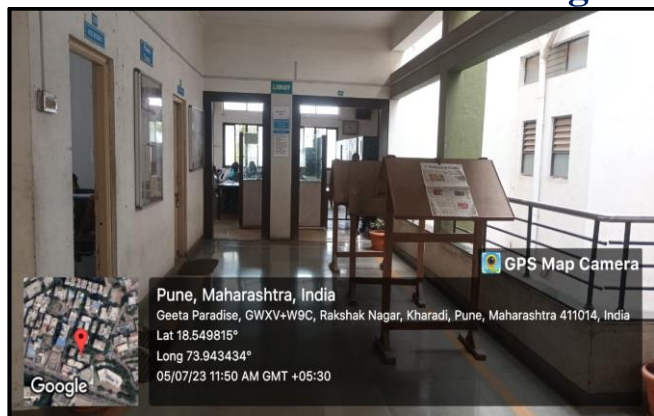

College Library Facility



Reading Room



Library stacking area

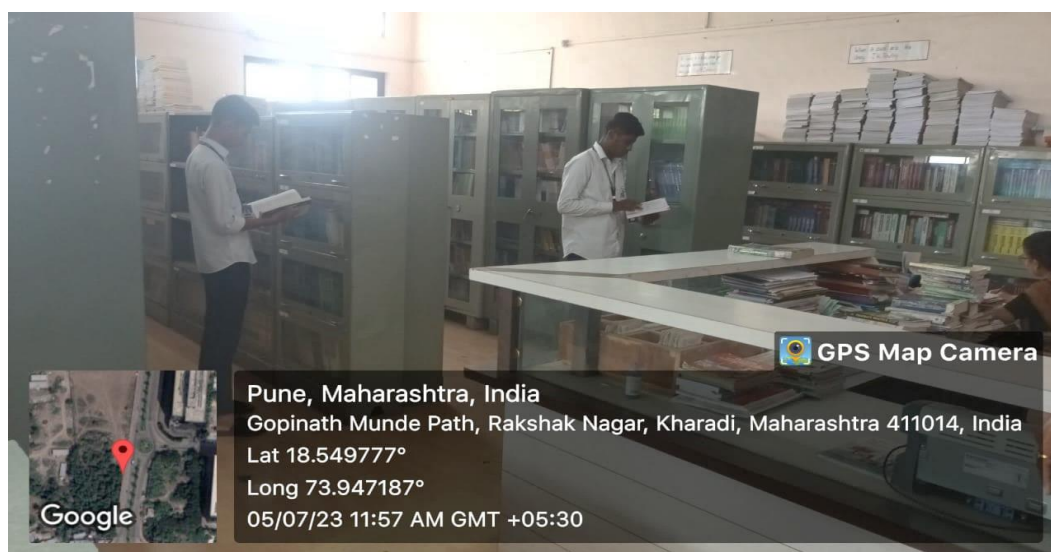

Pharmaceutical Industry Lab/ Machin room



PRINCIPAL
Pune District Education Association's
Shankarrao Ursal College of Pharmaceutical
Sciences & Research Centre,
Kharadi, Pune-411014.

Central Instrumentation Laboratory



Museum



PRINCIPAL
Pune District Education Association's
Shankarrao Ursal College of Pharmaceutical
Sciences & Research Centre,
Kharadi, Pune-411014.

Medicinal Plant Garden





PRINCIPAL
Pune District Education Association's
Shankarrao Ursal College of Pharmaceutical
Sciences & Research Centre,
Kharadi, Pune-411014.

B. Administrative area

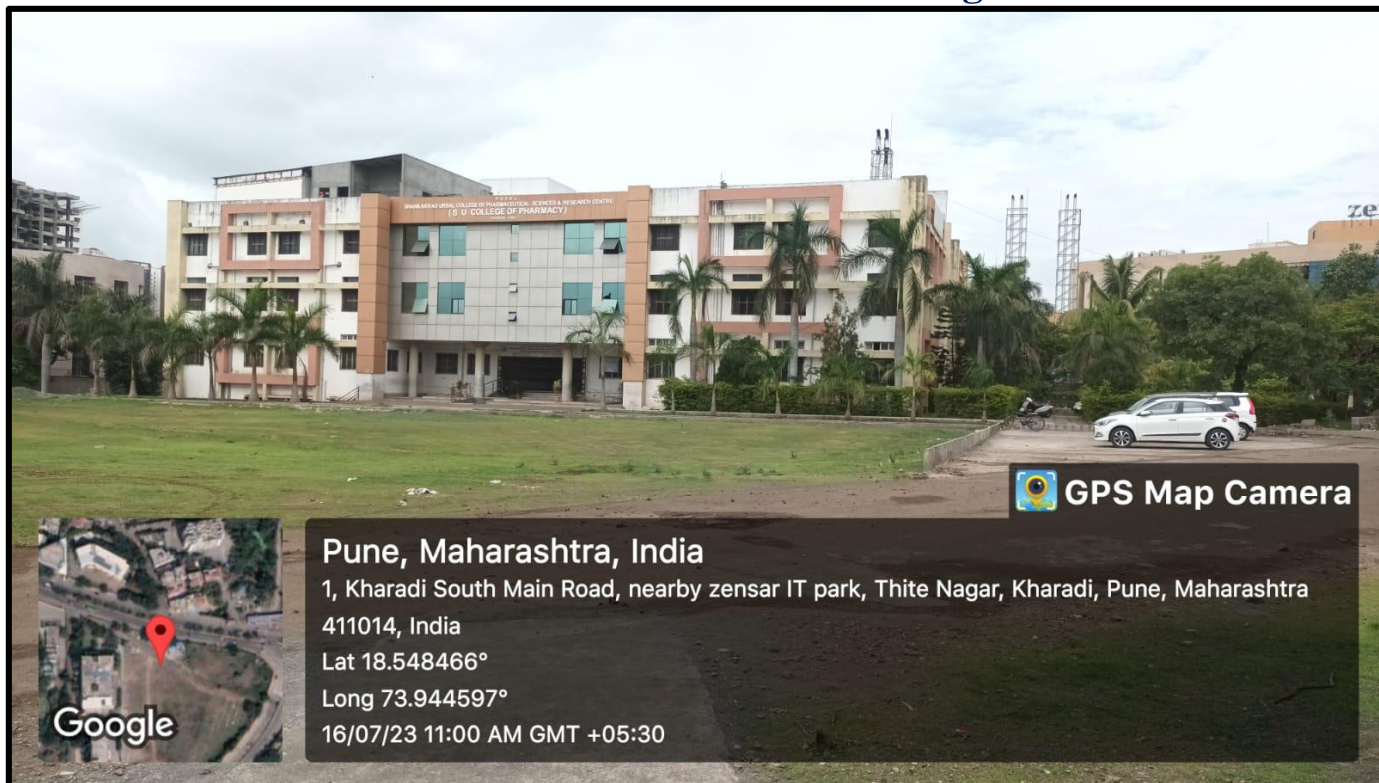

PRINCIPAL
Pune District Education Association's
Shankarrao Ursal College of Pharmaceutical
Sciences & Research Centre,
Kharadi, Pune-411014.

Front view of Institute building



Principal Cabin

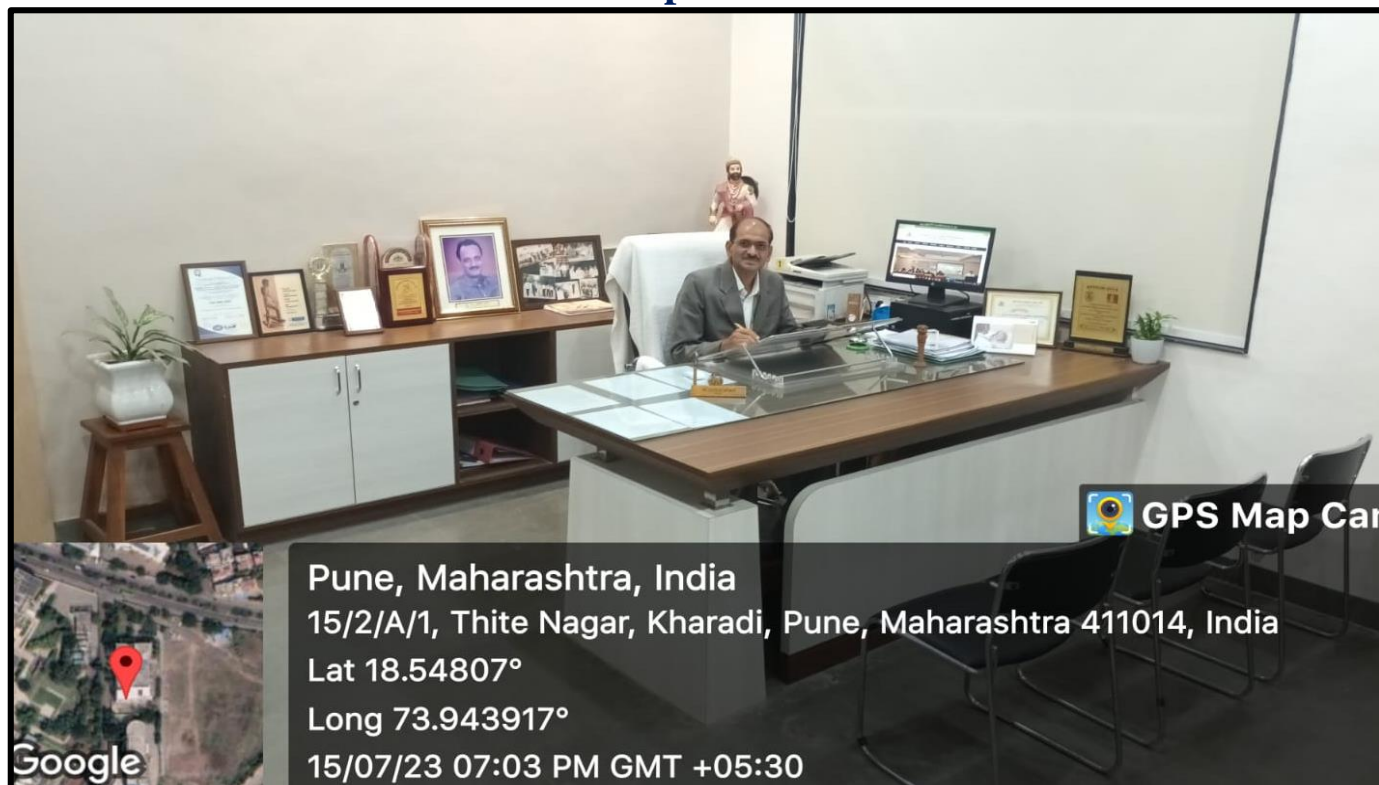



PRINCIPAL
Pune District Education Association's
Shankarrao Ursal College of Pharmaceutical
Sciences & Research Centre,
Kharadi, Pune-411014.

Administrative area

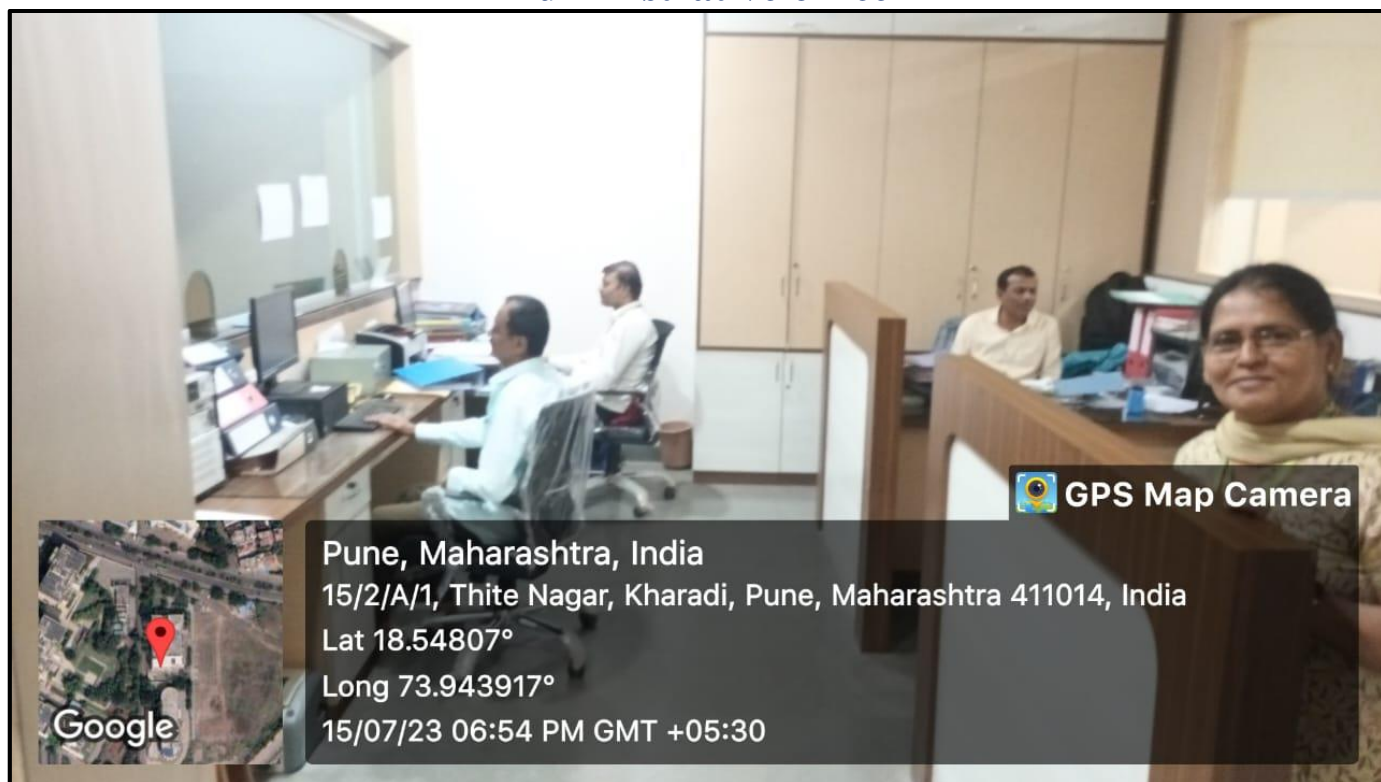

Administrative office





PRINCIPAL
Pune District Education Association's
Shankarrao Ursal College of Pharmaceutical
Sciences & Research Centre,
Kharadi, Pune-411014.

Board room

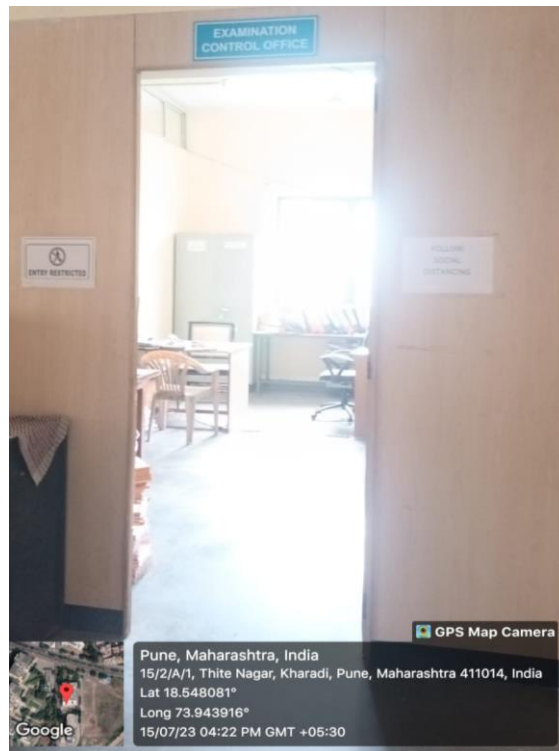

PRINCIPAL
Pune District Education Association's
Shankarrao Ursal College of Pharmaceutical
Sciences & Research Centre,
Kharadi, Pune-411014.

Examination Control room



Examination Block



PRINCIPAL
Pune District Education Association's
Shankarrao Ursal College of Pharmaceutical
Sciences & Research Centre,
Kharadi, Pune-411014.

Training and Placement Cell





PRINCIPAL
Pune District Education Association's
Shankarrao Ursal College of Pharmaceutical
Sciences & Research Centre,
Kharadi, Pune-411014.

**Pune District Education Association's
Shankarrao Ursal College of Pharmaceutical Sciences and Research Centre, Kharadi, Pune.**

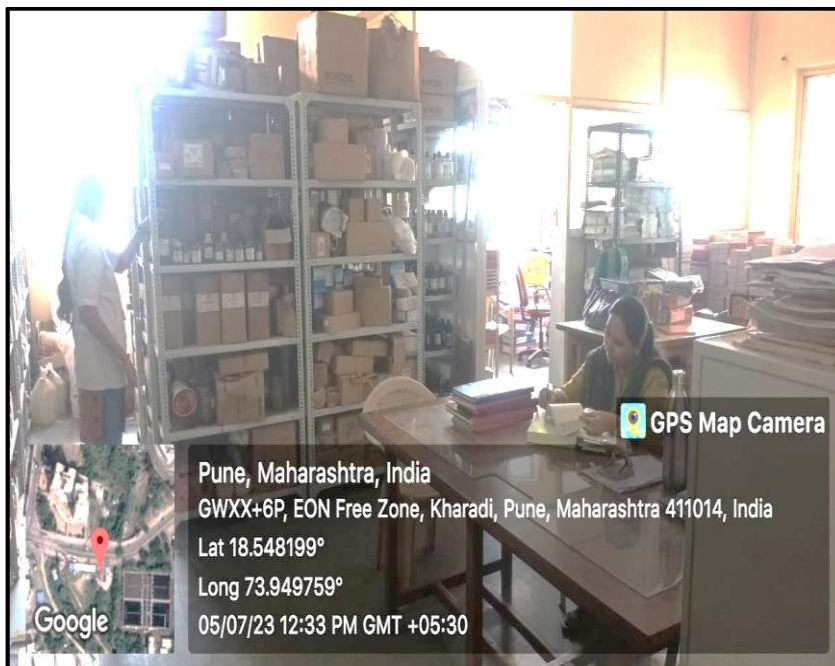
Store room



PRINCIPAL
 Pune District Education Association's
 Shankarrao Ursal College of Pharmaceutical
 Sciences & Research Centre,
 Kharadi, Pune-411014.

C. Amenities area





PRINCIPAL
Pune District Education Association's
Shankarrao Ursal College of Pharmaceutical
Sciences & Research Centre,
Kharadi, Pune-411014.

First Aid cum Sick room & Girls common room Facility

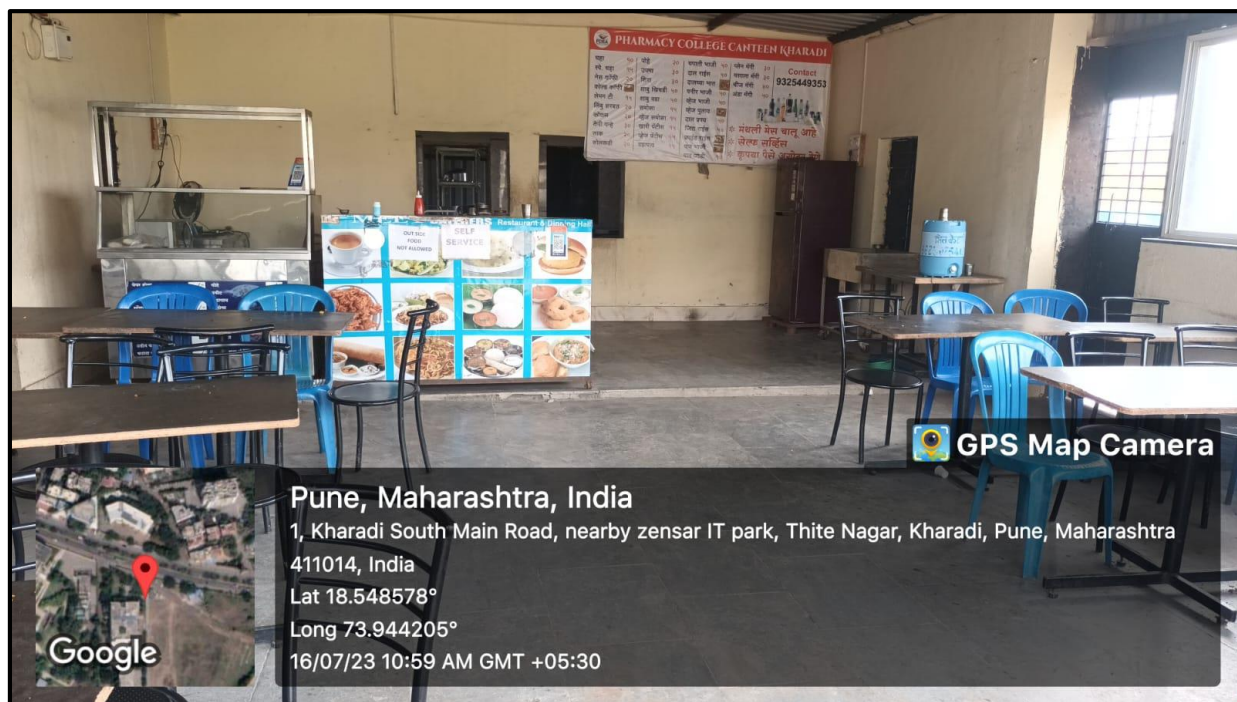

Canteen





PRINCIPAL
Pune District Education Association's
Shankarrao Ursal College of Pharmaceutical
Sciences & Research Centre,
Kharadi, Pune-411014.

Yoga and Meditation Facility

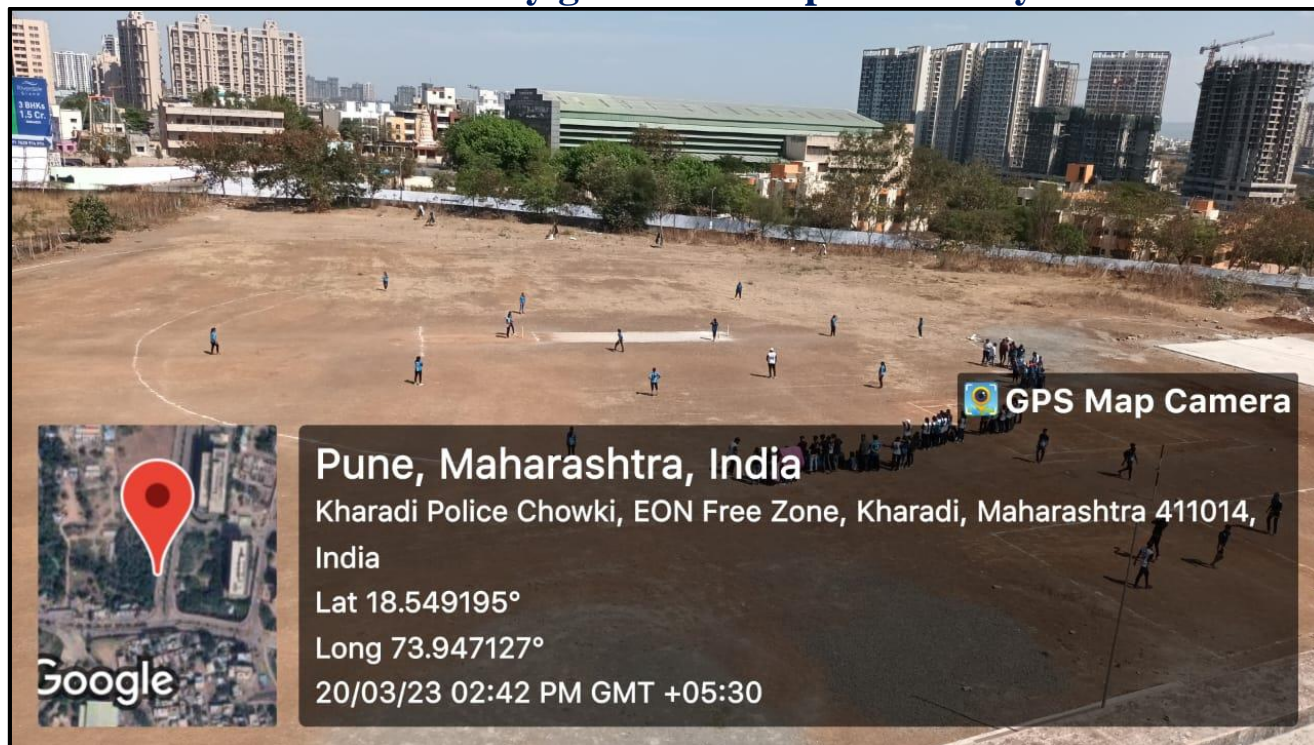

PRINCIPAL
Pune District Education Association's
Shankarrao Ursal College of Pharmaceutical
Sciences & Research Centre,
Kharadi, Pune-411014.

Outdoor Play ground and Sports facility



PRINCIPAL
Pune District Education Association's
Shankarrao Ursal College of Pharmaceutical
Sciences & Research Centre,
Kharadi, Pune-411014.

**Pune District Education Association's
Shankarrao Ursal College of Pharmaceutical Sciences and Research Centre, Kharadi, Pune.**



Indoor sports facility



PRINCIPAL
 Pune District Education Association's
 Shankarrao Ursal College of Pharmaceutical
 Sciences & Research Centre,
 Kharadi, Pune-411014.

Solar System (20 Kw Rooftop Solar Photovoltaic System):



Rooftop Solar Photovoltaic System



Solar System –Inverter



24/7 Electricity backup system

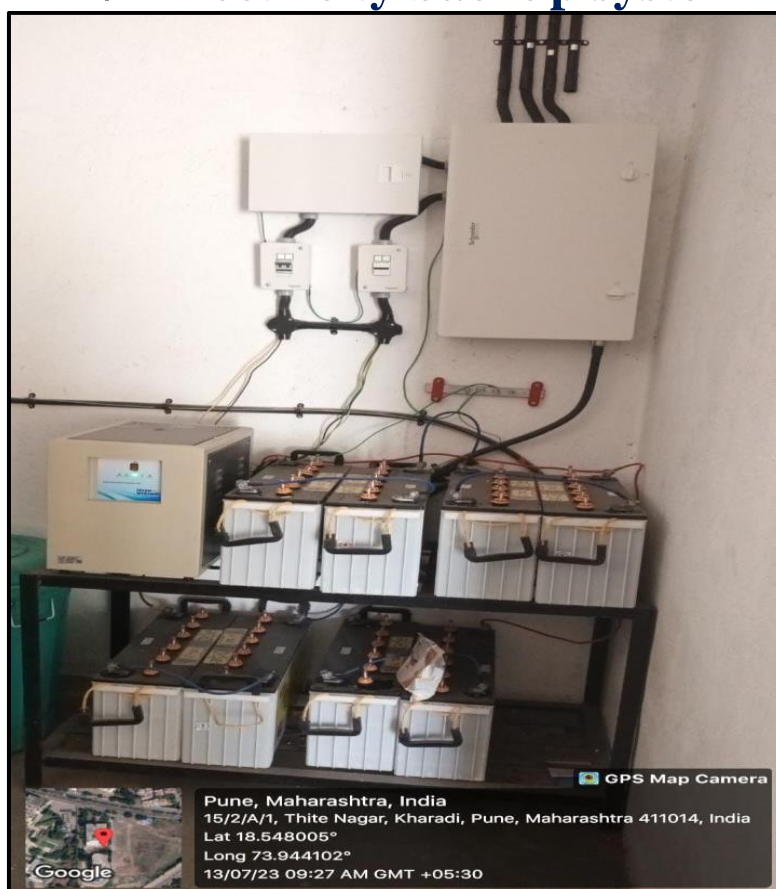

Fire fighting system

PRINCIPAL
Pune District Education Association's
Shankarrao Ursal College of Pharmaceutical
Sciences & Research Centre,
Kharadi, Pune-411014.



24 x 7 CCTV Camera Surveillance and Wifi System



Open gymnasium facility



Physically Disabled student facility

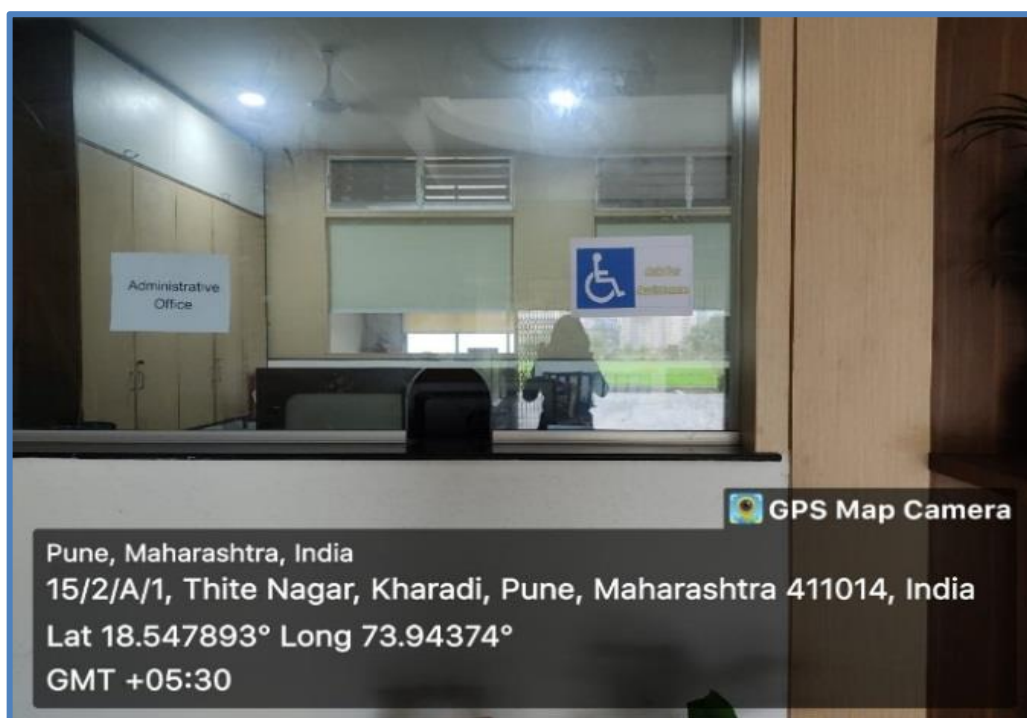
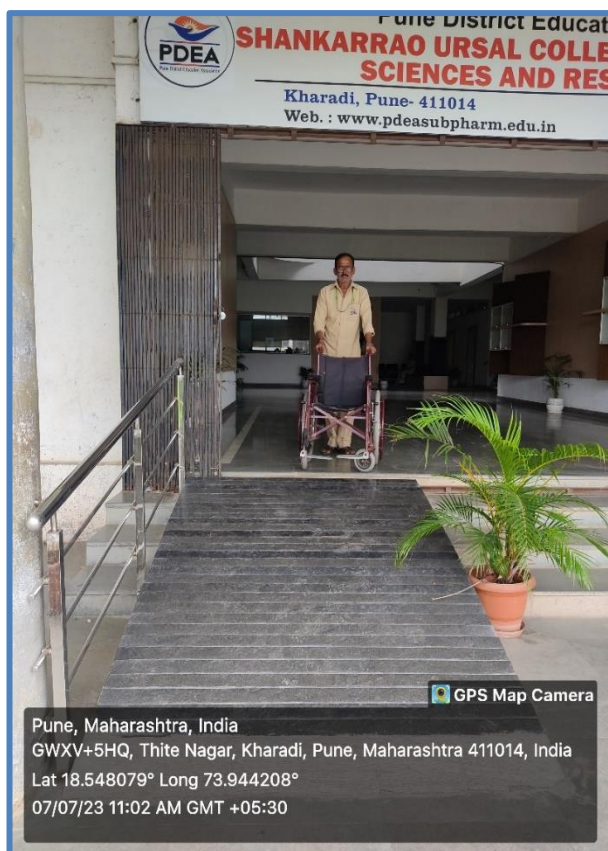

Parking Facility for Student and Staff

